

# QUICK START OF VMZ SOLAR AWNING BLIND

GB

The **ZWP SA 4 remote control** is supplied in one packaging with the awning blind.  
The awning blind is **factory programmed** on channel No. 1 !!!

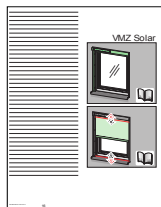

Install the awning blind in accordance with the **NC9AR**

Put batteries into the remote control

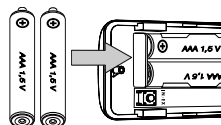

Check the operation of the awning blind

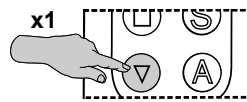

Check the operation of the awning blind folding

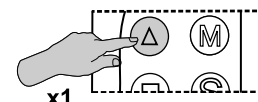

Information concerning programming, change of parameters, changes in configuration settings, calling individual functions is contained in the Programming and Usage Instructions (code NC9AS).

**If the awning blind is working properly, you do not need to perform any additional steps!!!**

The awning blind is equipped with the **manual operating button** positioned in its upper part. It enables control of the awning blind in case of losing the remote control or wearing off its batteries. If after mounting the awning blind cannot be launched via the remote control, check operation with the **manual operating button**.

If the awning blind works with the manual operating button, and yet it cannot be launched via remote control, make

**RESET** and go to **PROGRAMMING!!!**

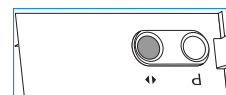

## RESET SIGNALLING

### RESET OF THE AWNING BLIND



### RESET OF THE REMOTE CONTROL



## PROGRAMMING SIGNALLING

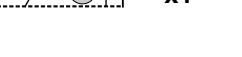
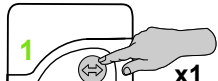

### END OF PROGRAMMING

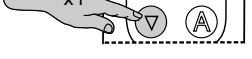
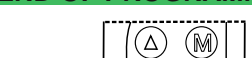

## ADDITIONAL INFORMATION

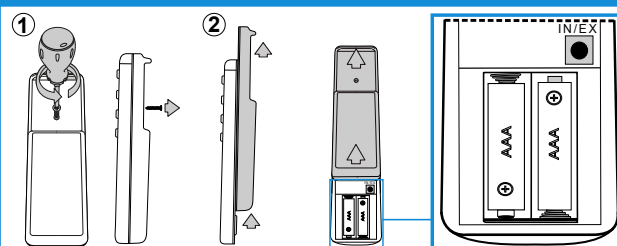

1. Screw out the screw on the back of the remote control
2. Pull out up back part of the remote control to access IN/EX programming button

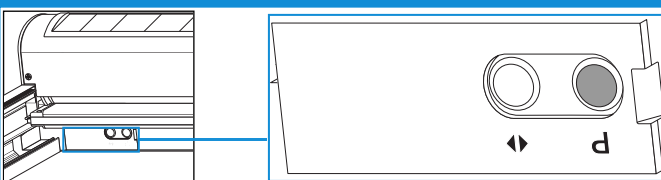

### Choose one of four available channels e.g. No. 1

- 1 – channel one – control of the awning blind No. 1
- 2 – channel two – control of the awning blind No. 2
- 1 – channel three – control of the awning blind No. 3
- 1 – channel four – control of the awning blind No. 4
- 1 2 3 4 – joint channel – simultaneous control of max. four awning blinds

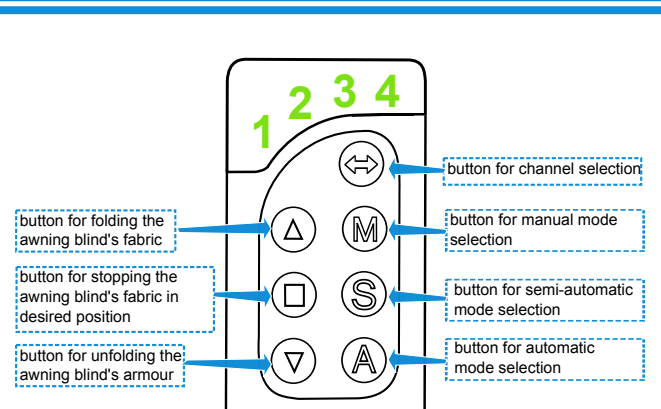
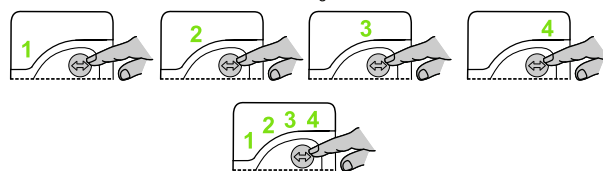

Calling other procedures such as DELETE, EXCLUDE, LEARN MODE, DEVICE CONNECTION is described in the programming and usage instructions attached to the VMZ Solar awning blind. Information on how to perform programming of Z-Wave devices with the use of controllers of other manufacturers is to be found in the manuals of these devices.